

Centre manager

The Village
123 Retirement Road
Brisbane QLD 4000

Tuesday, 12 February 2019

Dear sir:

Please find attached the results of our calculations of the reverberation time and appropriate remedial action for your retirement village common room.

Absorption should be placed on the ceiling and be placed on the walls centred around seated head height where possible. Locations, sizes and colours can be discussed. UltraQuiet tiles are suitable for both. Example pictures are included at the end of this document. The material referenced can be found in the attached price list.

Regards,



Andrew Steel
M.A.A.S M.A.E.S

Common room – The Village

Reverberation Time (RT60) Calculations

Treated with a UltraQuiet White 50mm ceiling panels 20m² and UltraQuiet White 50mm wall panels 10m² (results apply to these materials only).

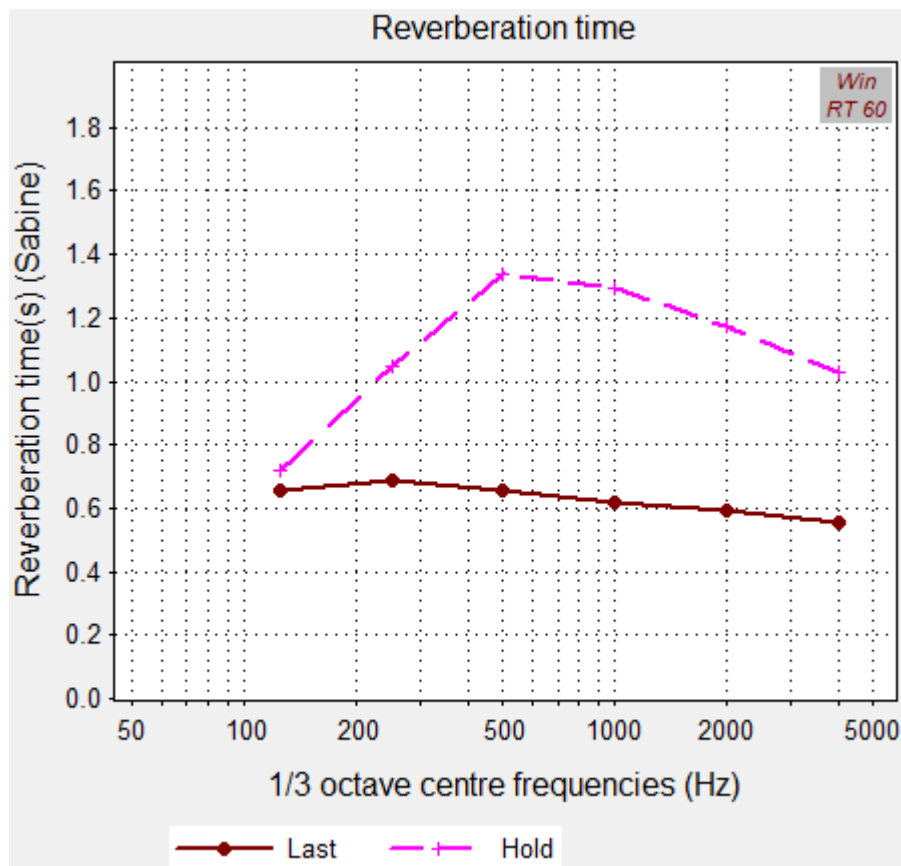

Pink line – current state

Brown line – acoustically treated state

The Australian Standard AS/NZS 2017:2000 recommends the following reverberation times for this type of room;

RESIDENTIAL BUILDINGS	
Hotels and motels	
Dining rooms	<1.0s
Retirement homes/villages	0.8s

Areas with hearing impaired occupants are suited to slightly lower reverberation time.

ultrafonic

make it sound better

Examples;



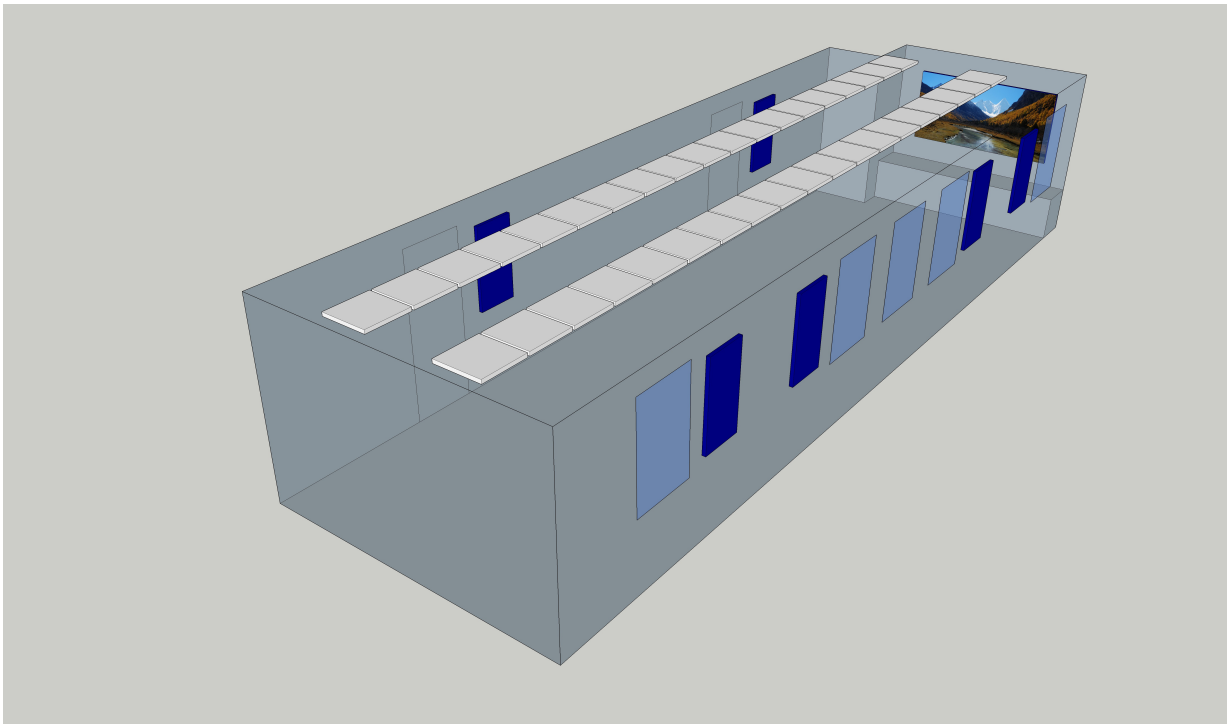
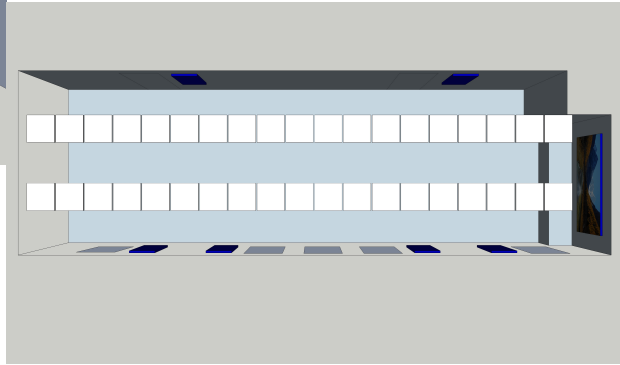
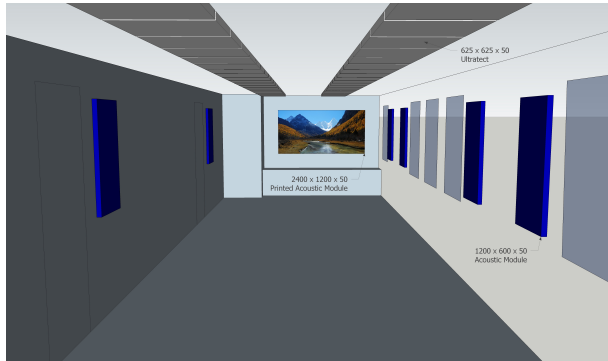

Additional.

Before



After

